

RS

MV outdoor switch disconnecter Manual operating NNO/NNP



CHARACTERISTICS

- High performance parameters
- Available with breaking chambers or arcing contacts
- Excellent anti-corrosion protection
- Module design which allows to assemble apparatus very easily on the top or next to a pole
- Equipped with elastic connector and with ice-proof self-counterblow contact system
- Available with composite and porcelain insulators
- Version with motor operating mechanism NSL60 available with remote control
- Possibility of working realisation in three-position with earthing switch: closed/open/earthed
- Padlock locking system available

SPECIFICATION

Item	Parameter	Value	
		With arcing contact	With air breaking chamber
1.	Rated voltage	24 [kV]	
2.	Rated frequency	50 [Hz]	
3.	Rated continuous current	630 [A]	
4.	Lightning surge test voltage: -earth and pole to pole insulation -contact to contact insulation	125 [kV] 145 [kV]	
5.	Rated alternating test voltage: -earth and pole to pole insulation -contact to contact insulation	50 [kV] 60 [kV]	
6.	Rated current: - low inductive reactance circuit - in ring network circuits - in cable and overhead lines, idle state	20 [A] 10 [A] 20 [A]	630 [A] 630 [A] 25 [A]
7.	Rated peak current	40 [kA]	
8.	Rated short-circuit current, 1 sec.	16 [kA]	
9.	Mechanical strength	1000 cycles	

DRAWING

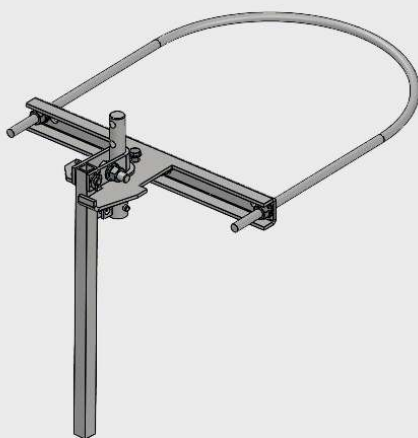

NNO - Version for spun concrete pole

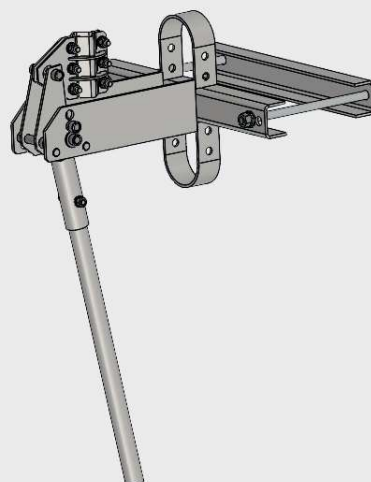

NNP - Version for ŽN/BSW pole